

Craft Cabinet
Plans by The Handyman's Daughter™
Copyright 2024



Materials Needed

- ☐ One 4'x8' sheet of $\frac{3}{4}$ " melamine or plywood
- ☐ $\frac{1}{4}$ " plywood for the back
- ☐ Wood, laminate or melamine for the top
- ☐ Edge banding
- ☐ 1 $\frac{1}{4}$ " pocket hole screws
- ☐ Staples or $\frac{1}{2}$ " screws to attach the back
- ☐ 2" locking casters
- ☐ Shelf pins
- ☐ Cabinet door hinges and door pulls (optional)

Cut List

Part	Dimensions	Number of Parts
Side	18" x 31"	2
Bottom and Shelves	18" x 23 $\frac{1}{2}$ "	3
Stretchers	4" x 18"	2
Doors (optional)	12 $\frac{7}{8}$ " x 31"	2
Back ($\frac{1}{4}$ " plywood)	25" x 31"	1

Plywood/Melamine Cut Diagram

Note: The doors are optional.

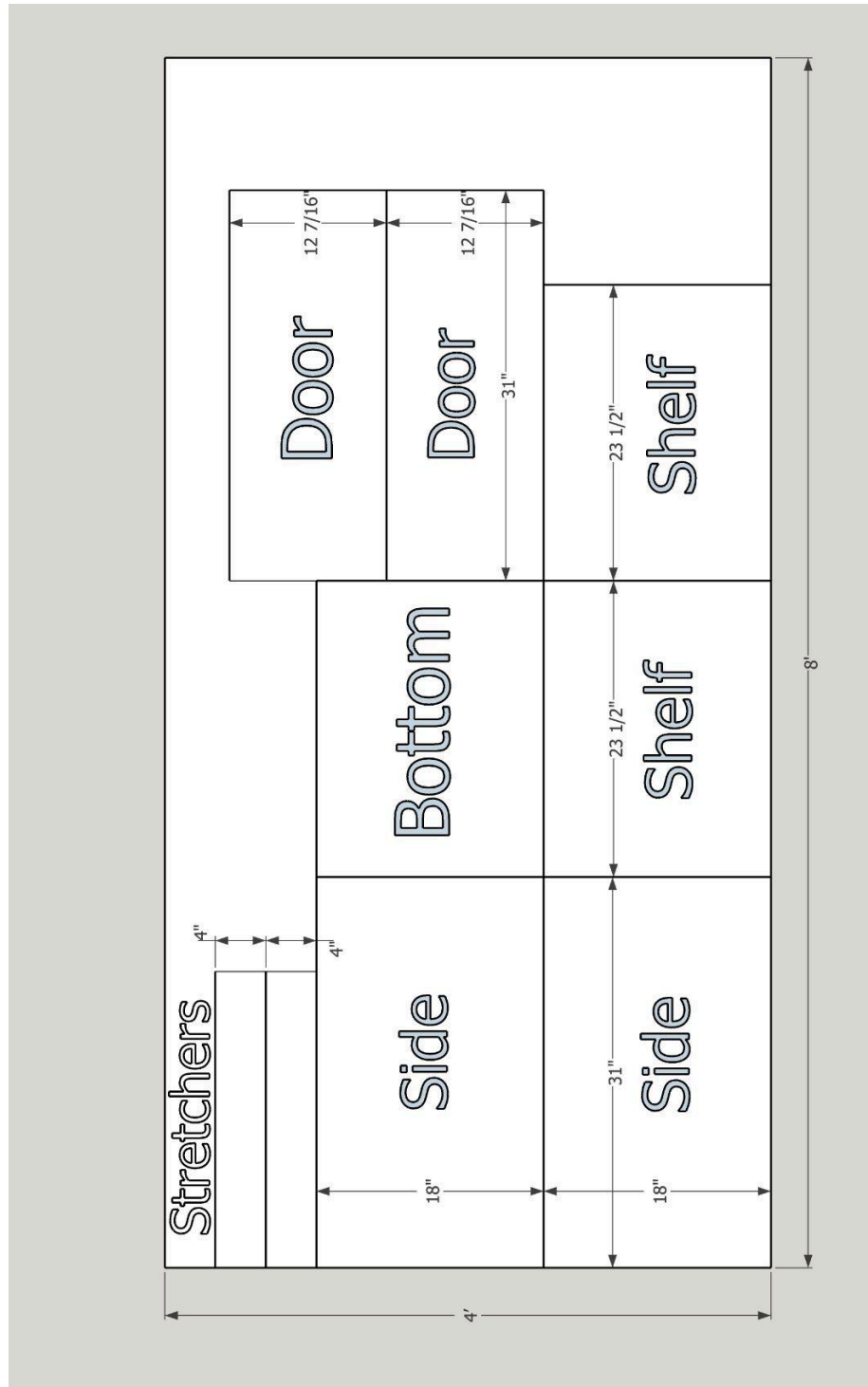

- ☐ [Drill pocket holes](#) along the two short sides of the bottom, as well as the two stretcher pieces.
- ☐ If you want adjustable shelves, [drill shelf pin holes](#) along the front and back edge of both of the side pieces before assembly. If you want fixed shelves, drill pocket holes along the short sides of both shelves.
- ☐ [Apply edge banding](#) to the front edge of the bottom, sides, shelves, and front stretcher.
- ☐ Attach the bottom of the cabinet box between the sides with 1 ¼" pocket hole screws.

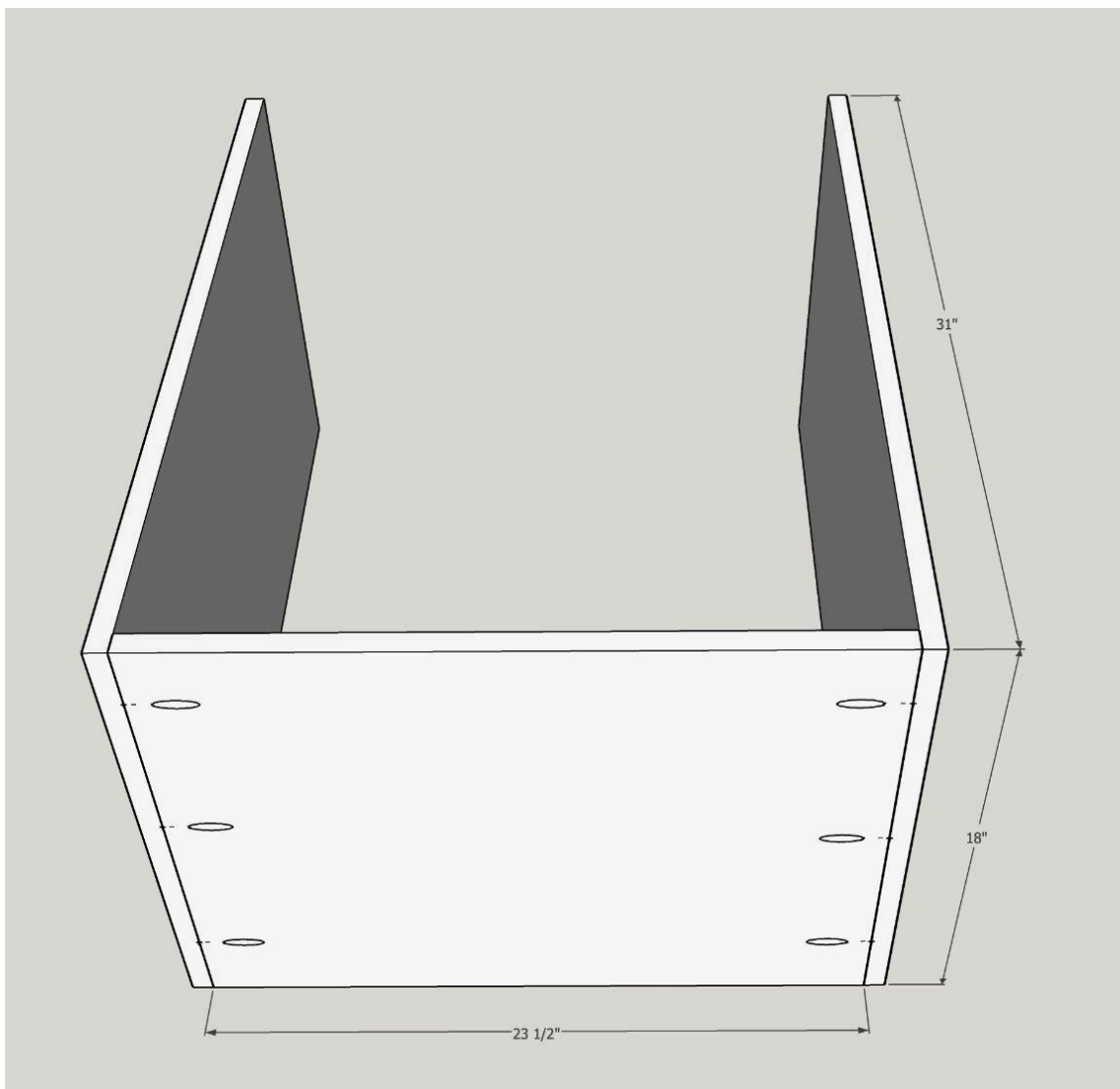

- ☐ Attach the front stretcher with the edge banding across the top of the front of the box with 1 ¼" pocket hole screws. Make sure it's flush with the top and front edge of the side panels.
- ☐ Attach the back stretcher with 1 ¼" pocket hole screws.

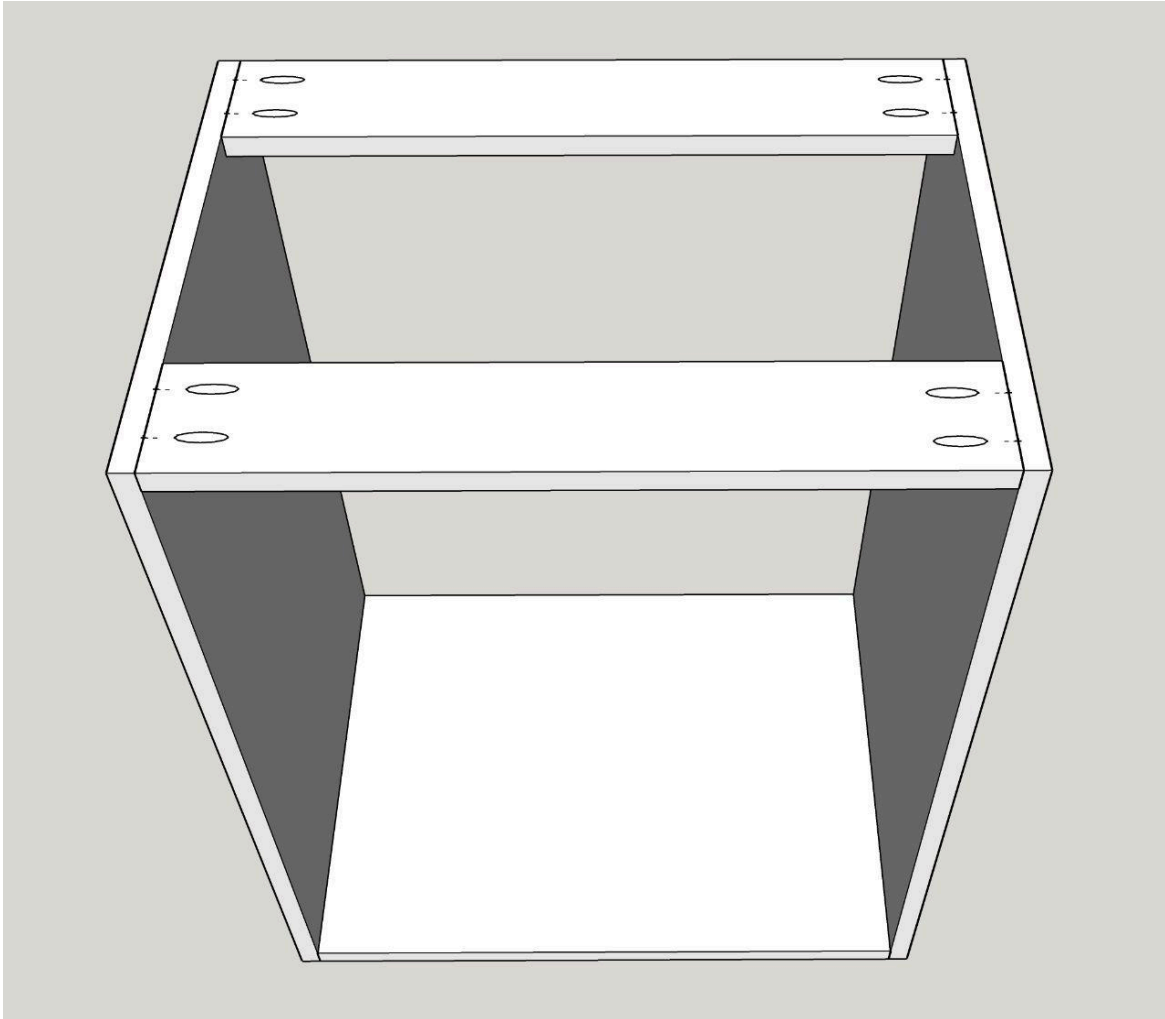

- ☐ If you prefer fixed shelves, measure and mark the position of each shelf carefully before attaching them to the sides with 1 ¼" pocket hole screws.

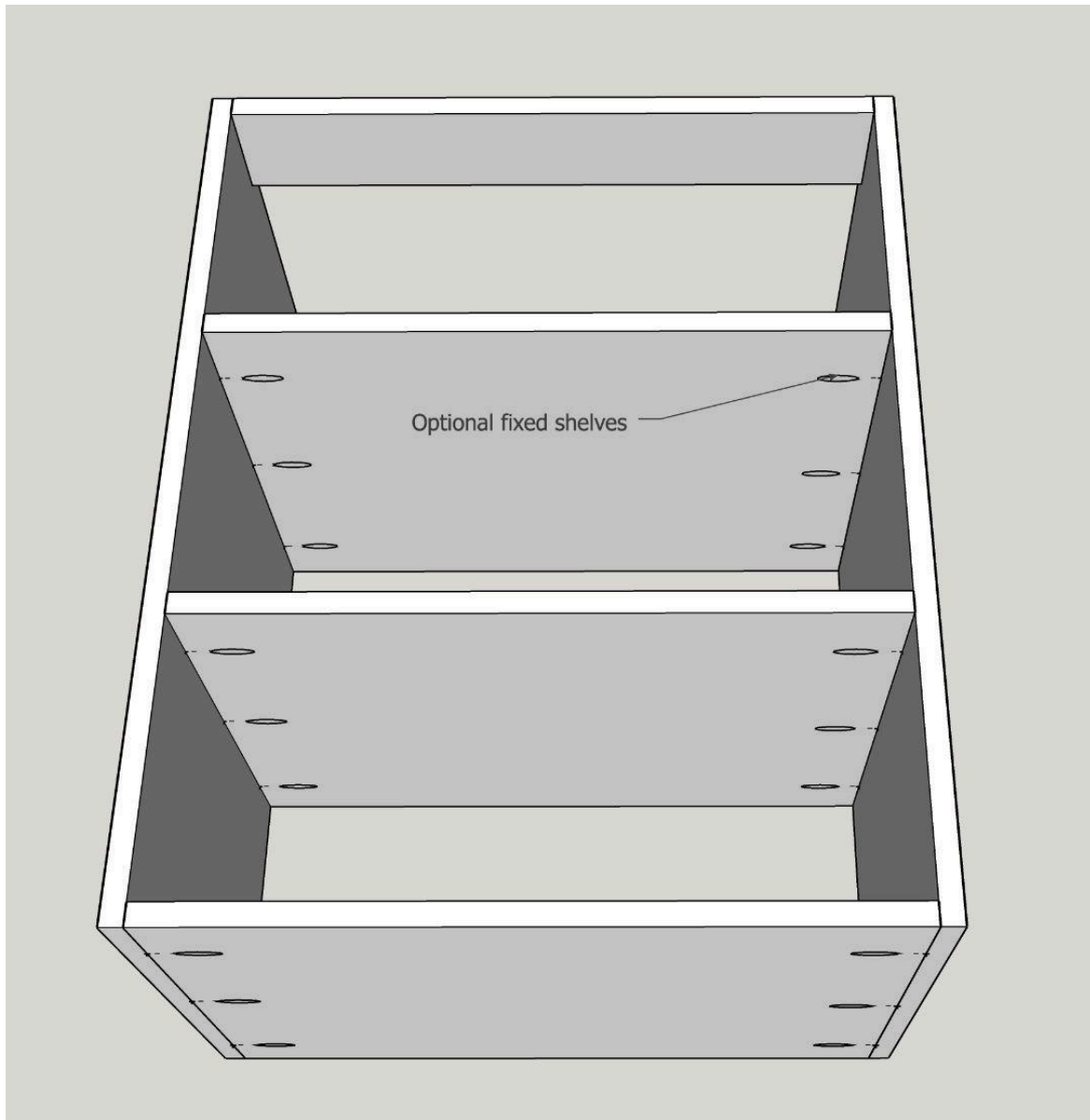

- ☐ Measure the distance across the diagonals of the cabinet box in both directions to see if the numbers match. If they do, your box is square. If they don't, squeeze the corners of the larger diagonal together to shift everything into place.
- ☐ Once the box is square, measure the length and width to determine the size of the cabinet back panel. I prefer to cut my back panels slightly undersized, so the edges aren't as visible when viewing the cabinet from the side.
- ☐ Attach the cabinet back panel with staples or $\frac{1}{2}$ " screws.

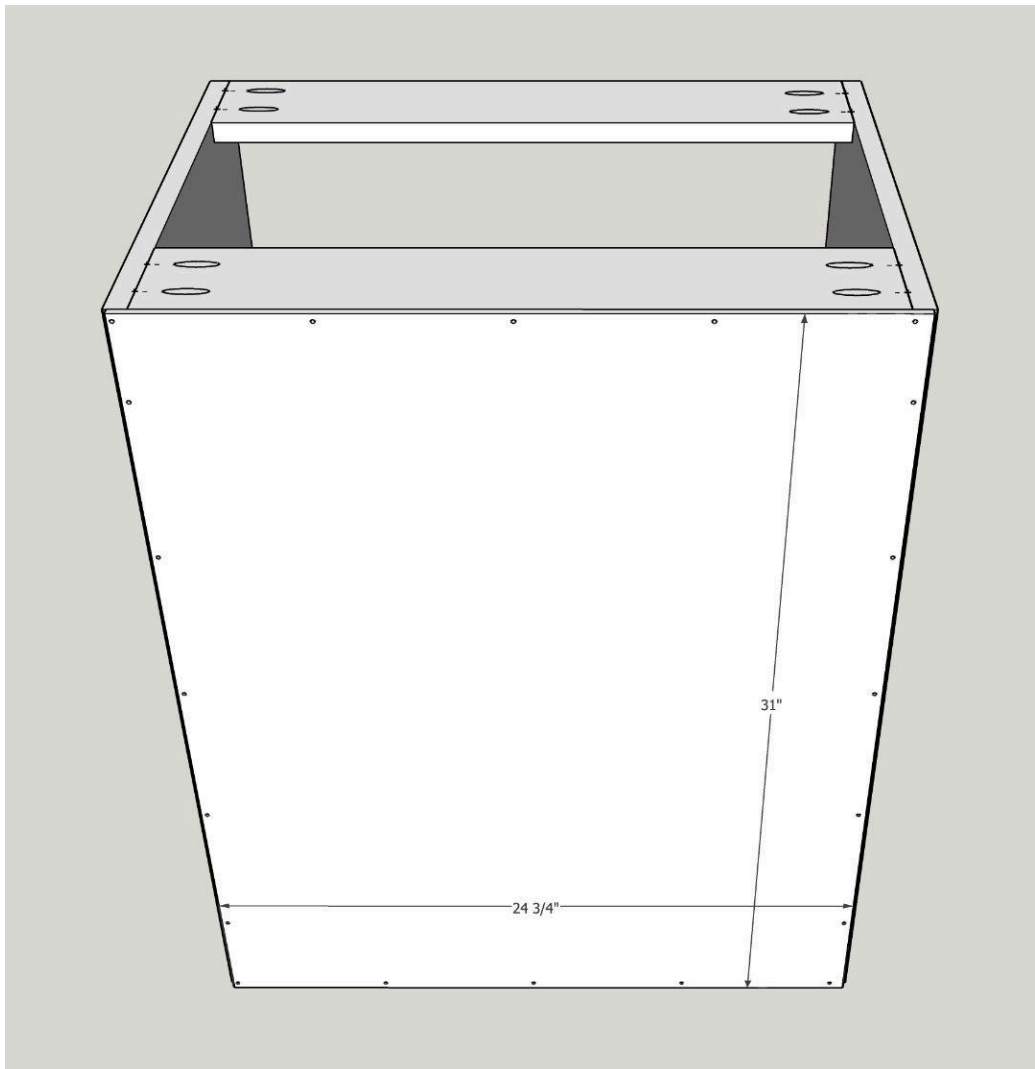

- ☐ Measure the length and width of the top of the cabinet to determine the size of the top.
 - ☐ If you plan to leave the shelves open, cut the top $\frac{3}{4}$ " bigger than the cart on all four sides.
 - ☐ If you want doors on the front, add $1\frac{1}{2}$ " to the front edge instead.
- ☐ If your top is solid wood, predrill holes in the stretchers that are slightly larger than the thickness of the screws you'll use to attach the top. This will allow for wood movement as humidity levels change with the seasons.
- ☐ Attach the top through the stretchers with screws that are short enough to not accidentally pop through the surface.

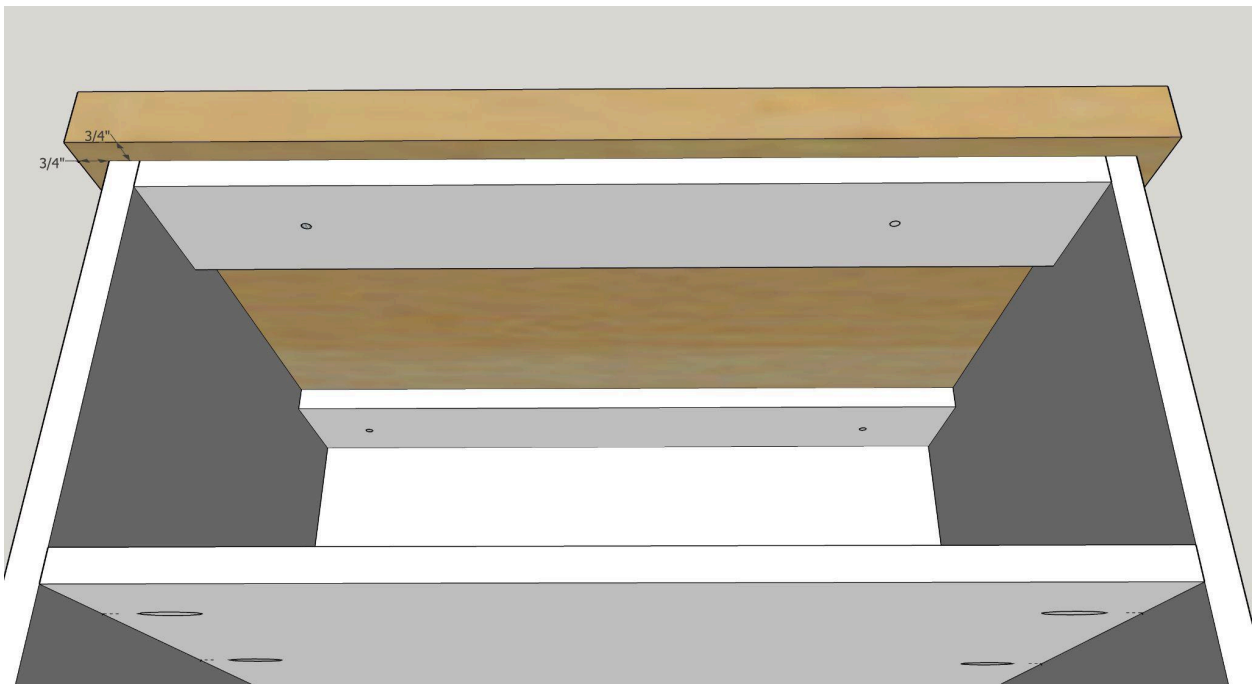

- ☐ If you want to make your cabinet mobile, add 2" casters to the bottom. Consider using locking casters if it will be holding a machine that has moving parts so it doesn't wiggle.

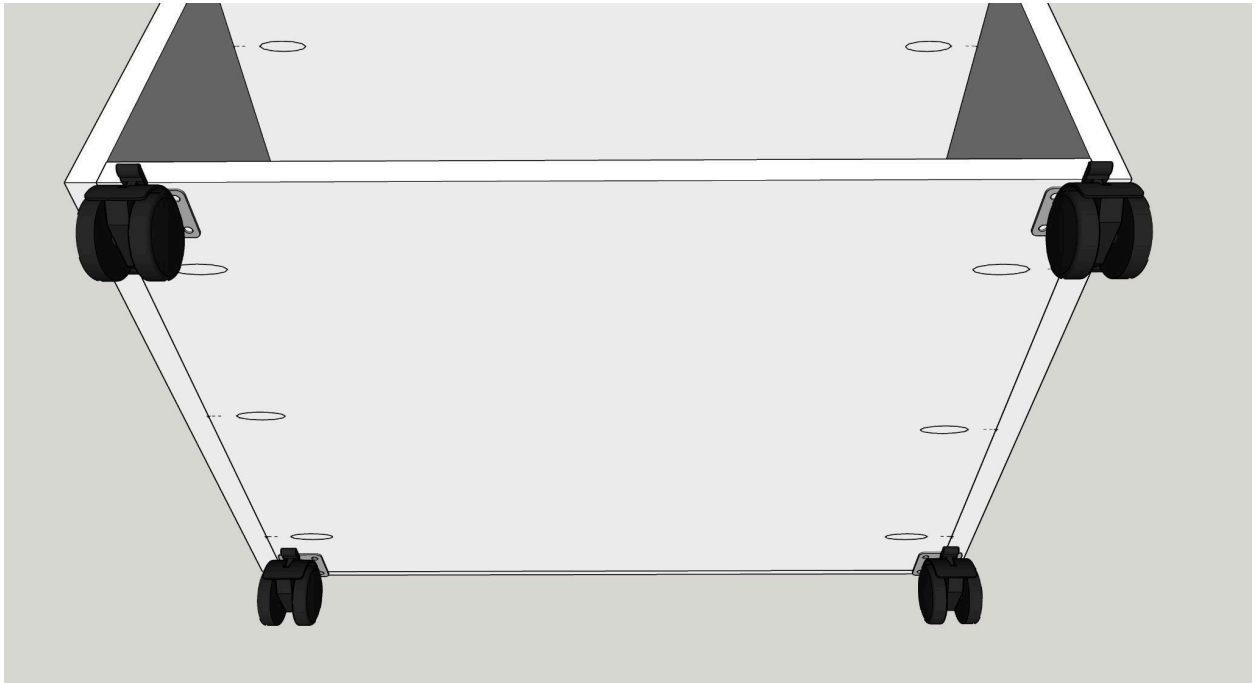

- ☐ If you want to add doors, you can cut them from the same melamine as the rest of the cabinet and apply edge banding around the outside edge, or [make your own Shaker style doors](#) if you want to get fancy.
- ☐ Check out my tutorials on [how to drill concealed hinge holes](#) and [how to install cabinet hinges](#) for more details on these steps.



Enjoy your new craft cabinet! If you have any questions, feel free to email me at hello@thehandymansdaughter.com and I'll do my best to help you out!