

Entryway Bench with Storage Bins
Plans by The Handyman's Daughter
Copyright 2018

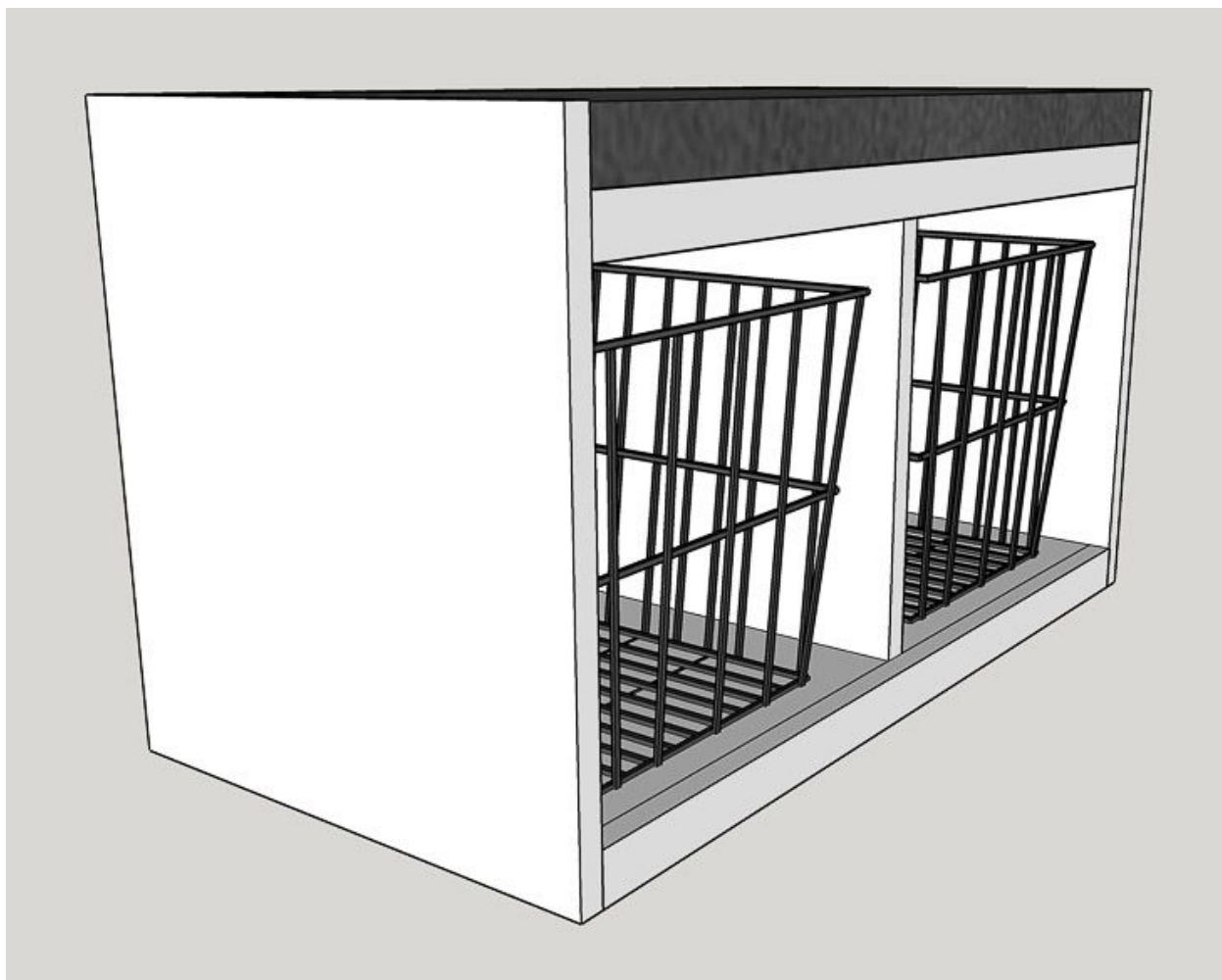

Materials Needed for DIY Entryway Bench

Refer to the blog post [here](#) for sources.

- 4' x 4' half sheet of 3/4" plywood
- One 8' long 1 x 2 board
 - I used preprimed 1 x 2 trim board.
- Circular saw or table saw
 - You can also get the cuts made for you at the home improvement store.

- Power drill
- Pocket hole jig
- 1 1/4" pocket hole screws
- Square
- Nail gun and 1 1/2" brad nails
- Wood filler
- Sandpaper
- Edge banding (optional)
- Paint
- Storage bins

Materials Needed for the Upholstered Cushion

- 2' x 2' sheet of 1/4" plywood
- 1" upholstery foam
- Batting
- Staple gun and 1/4" staples
- Fabric or leather

Cut List

3/4" plywood

- 2 @ 16" x 18" (sides)
- 1 @ 29 1/2" x 18" (back)
- 2 @ 29 1/2" x 14 1/2" (top and bottom)
- 1 @ 14 1/2" x 14" (center divider)
- 2 @ 14" x 3/4" (optional additional supports)

1 x 2 trim board

- 2 @ 29 1/2"
- 1 @ 14 1/2" (underside support)

1/4" plywood

- 29 1/4" x 15 1/4"

$\frac{3}{4}$ " Plywood Cut Diagram

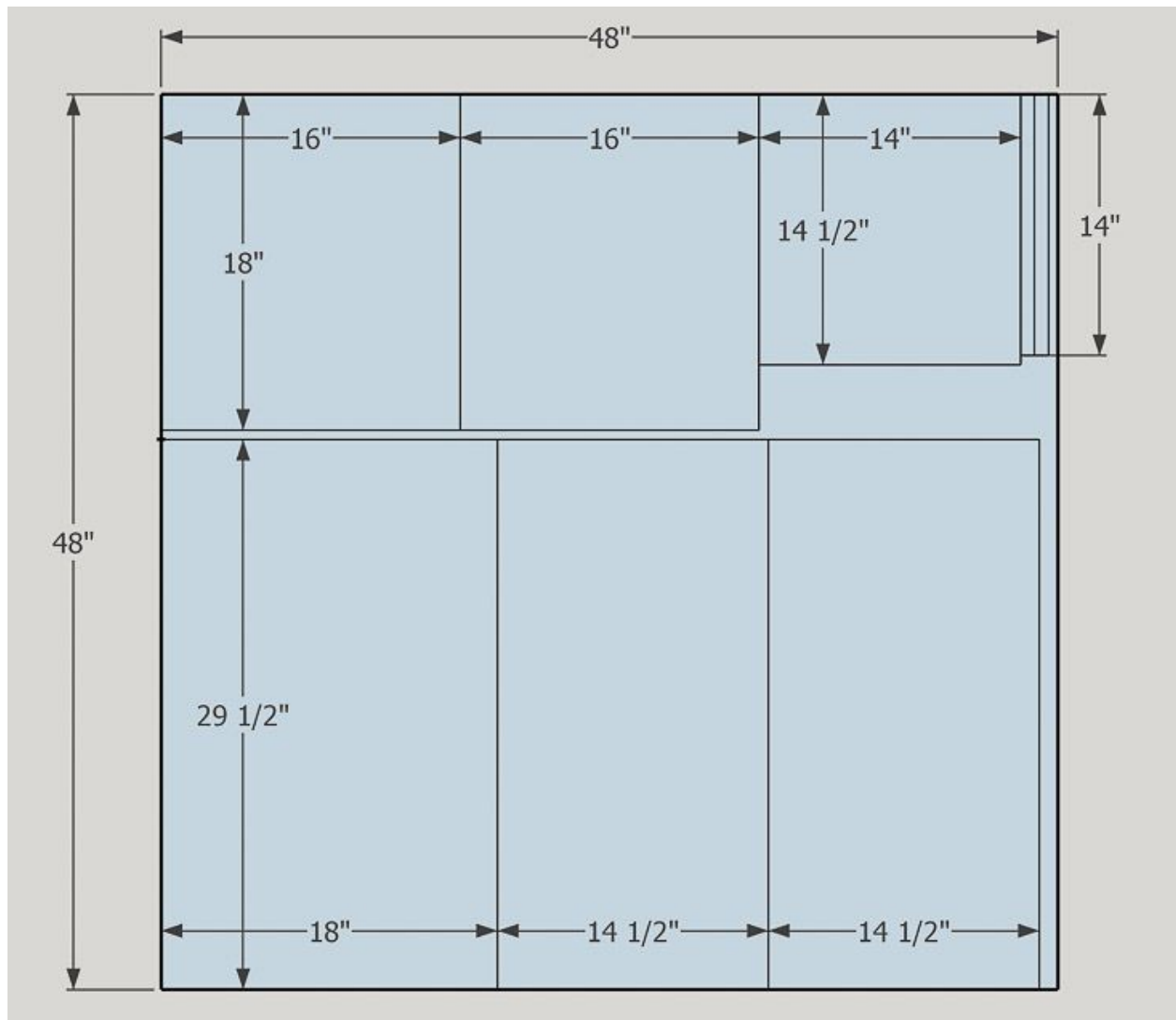

Instructions

Drill pocket holes down the short sides of the back piece, and along three sides of the top and bottom piece and center support.

Attach the back to the sides with 1 ¼" pocket hole screws.

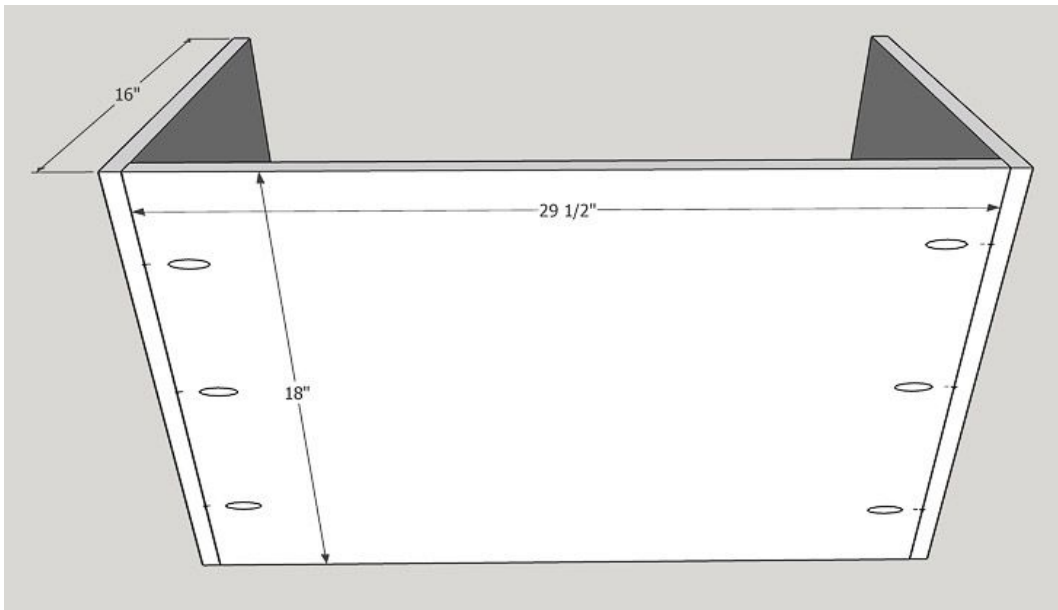

Attach the bottom piece 1 ½" up from the bottom with 1 ¼" pocket hole screws..

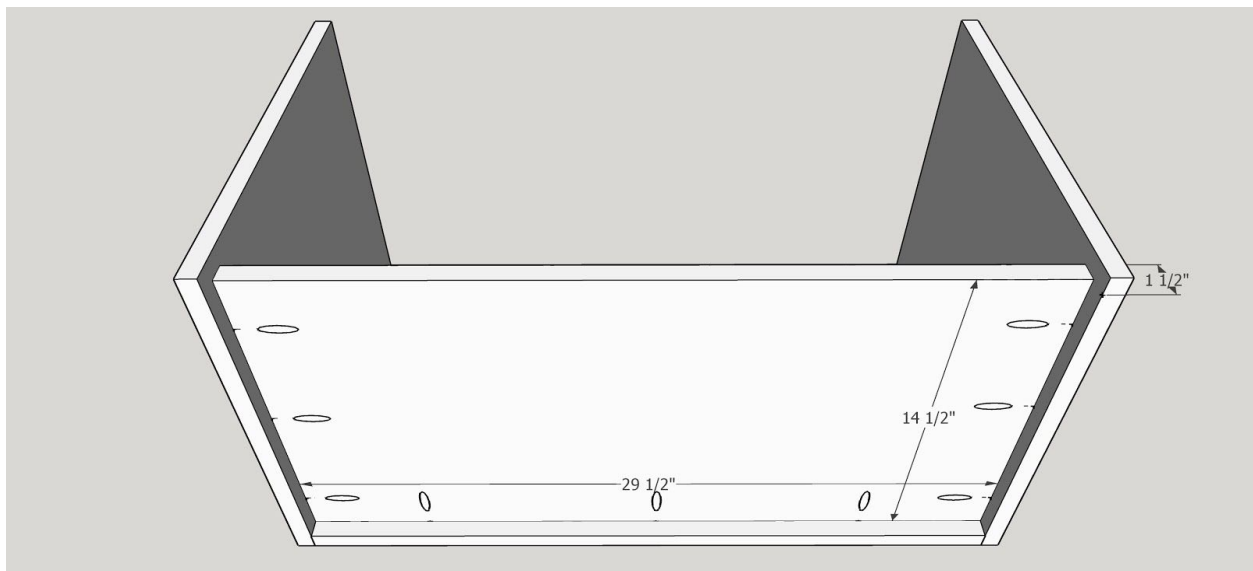

Mark the center of the interior and attach the center support to the bottom and back with 1 ¼" pocket hole screws.

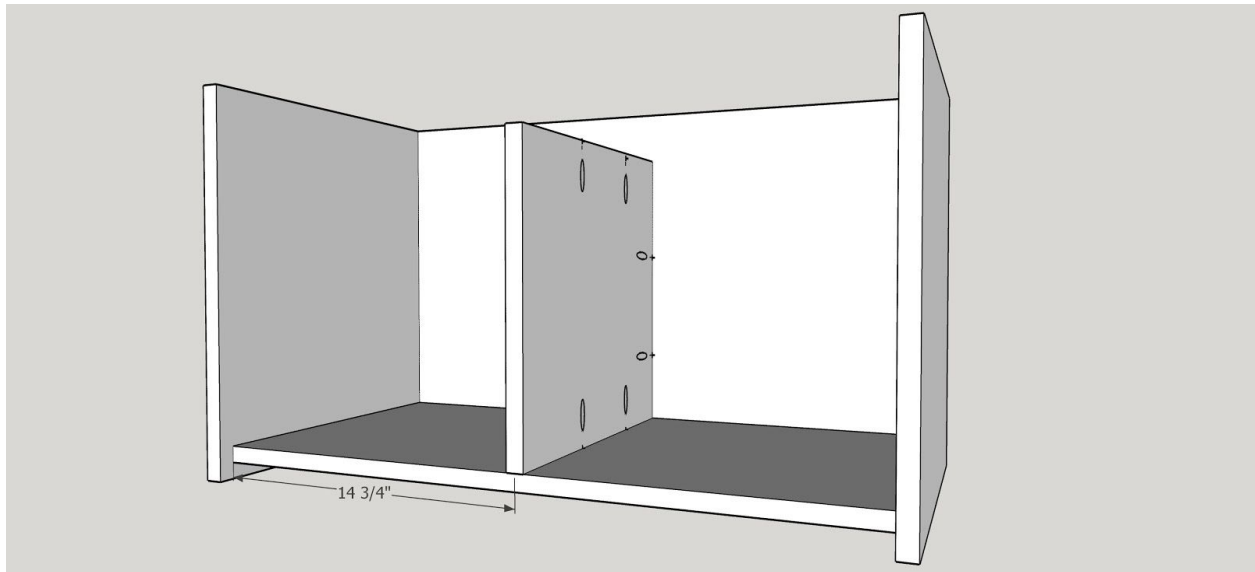

Finally, install the top with 1 ¼" pocket hole screws. Make sure it is level before screwing it into place. Add additional supports at the back corners if desired.

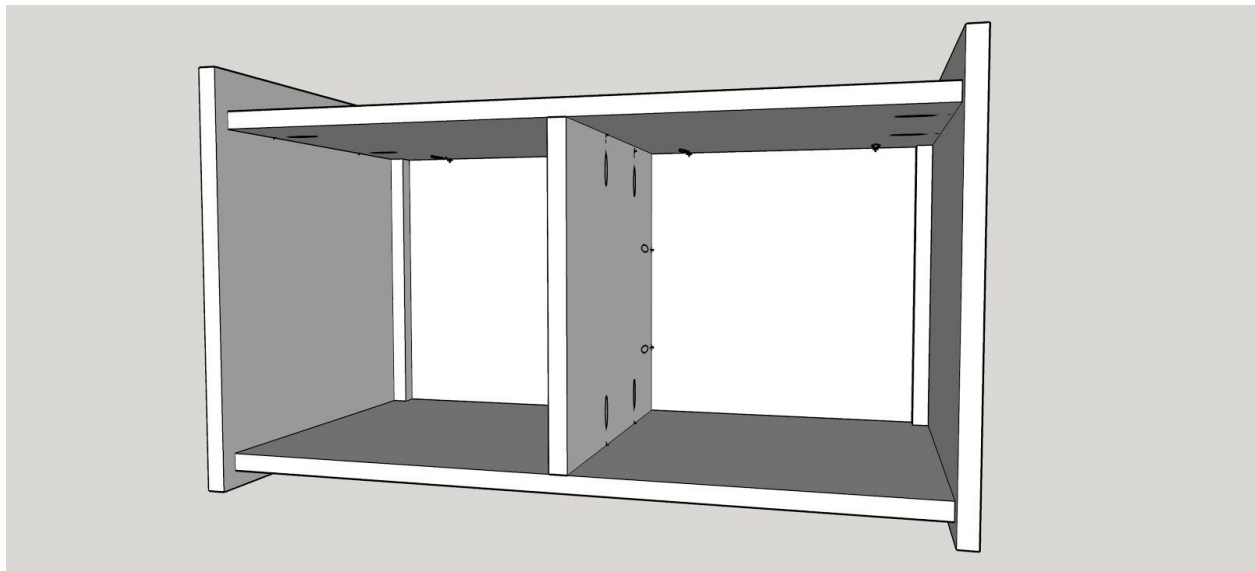

Attach supports to bottom with 1 ½" brad nails.

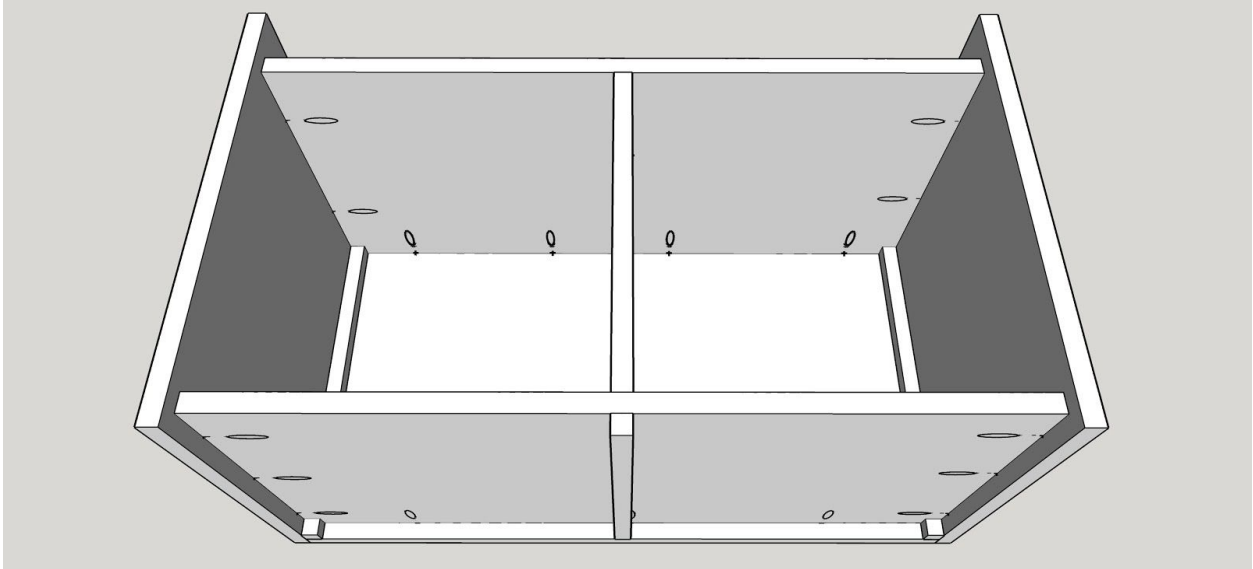

Attach front trim pieces to top and bottom with 1 ½" brad nails.

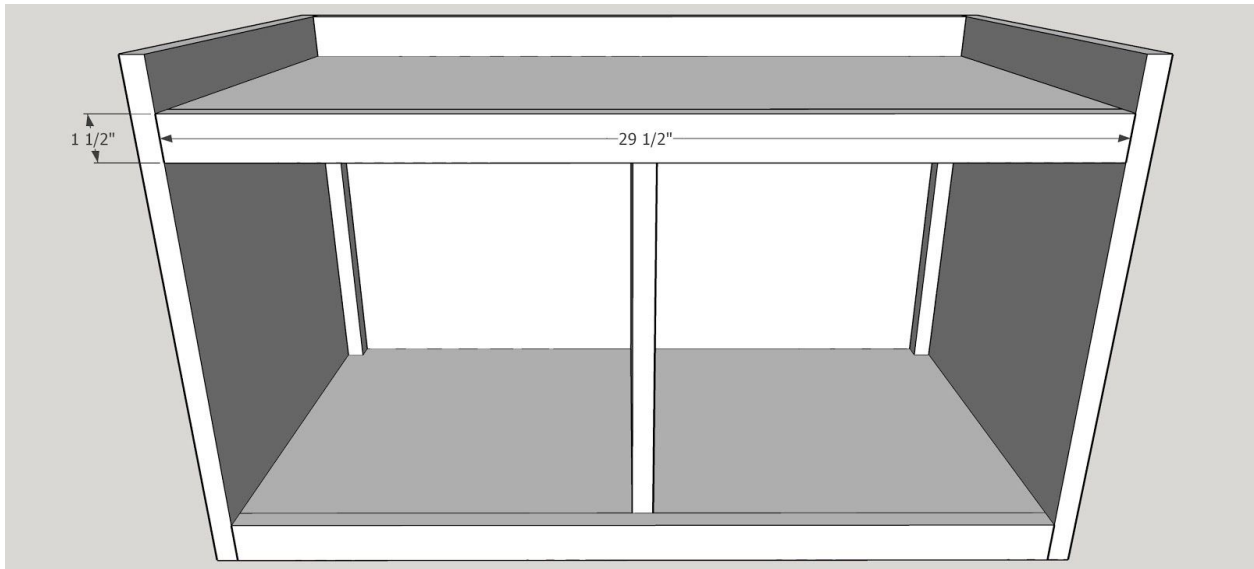

Fill any holes, gaps or exposed plywood edges with wood filler, then sand smooth when dry. Apply two coats of primer, then paint.

Follow the instructions in the blog post for upholstering the bench cushion.